

Price Guide 2017

Transportable Log Homes

Model	Lodge (Installed)	Delivery	BS.3632 Upgrade*	Model	Lodge (Installed)	Delivery	BS.3632 Upgrade*
The Alpine Compact - 2 Bedrooms - 39.47m ² (425ft ²)				The Cresta - 2 Bedrooms - 43.92m ² (473ft ²)			
75mm Log	£40,597.00	£941.00	£6,156.00	75mm Log	£46,996.00	£941.00	£6,420.00
150mm Log*	£50,580.00	£896.00	P.O.A	150mm Log*	£56,439.00	£896.00	P.O.A
The Tirol Annexe - 1 Bedroom - 48.44m ² (521ft ²)				The Brecon - 2 Bedrooms - 51.82m ² (558ft ²)			
75mm Log	£50,772.00	£941.00	£6,859.00	75mm Log	£55,477.00	£941.00	£6,827.00
150mm Log*	£60,738.00	£896.00	P.O.A	150mm Log*	£66,765.00	£896.00	P.O.A
The Sherwood - 2 Bedrooms - 54.35m ² (585ft ²)				The Alpine - 2 Bedrooms - 59.31m ² (638ft ²)			
75mm Log	£55,497.00	£941.00	£6,928.00	75mm Log	£59,726.00	£941.00	£7,620.00
150mm Log*	£66,925.00	£896.00	P.O.A	150mm Log*	£72,414.00	£896.00	P.O.A
The Lomond - 3 Bedrooms - 66.65m ² (717ft ²)				The Malvern - 2 Bedrooms - 72.41m ² (779ft ²)			
75mm Log	£65,188.00	£941.00	£7,642.00	75mm Log	£66,771.00	£941.00	£7,554.00
150mm Log*	£78,319.00	£896.00	P.O.A	150mm Log*	£80,170.00	£896.00	P.O.A
The Nordic - 3 Bedrooms - 79.66m ² (857ft ²)				The Pennine - 3 Bedrooms - 88.09m ² (948ft ²)			
75mm Log	£70,455.00	£941.00	£8,999.00	75mm Log	£77,881.00	£1,058.00	£8,989.00
150mm Log*	£84,489.00	£896.00	P.O.A	150mm Log*	£94,092.00	£1,007.00	P.O.A
The Grampian - 3 Bedrooms - 94.15m ² (1013ft ²)				The Cairngorm - 4 Bedrooms - 98.60m ² (1061ft ²)			
75mm Log	£88,038.00	£1,058.00	£9,047.00	75mm Log	£88,760.00	£1,058.00	£9,727.00
150mm Log*	£103,910.00	£1,007.00	P.O.A	150mm Log*	£105,676.00	£1,007.00	P.O.A
The New Highland - 3 Bedrooms - 98.72m ² (1063ft ²)				The Wicklow - 3 Bedrooms - 101.16m ² (1089ft ²)			
75mm Log	£87,035.00	£1,058.00	£9,496.00	75mm Log	£84,663.00	£1,058.00	£9,920.00
150mm Log*	£104,042.00	£1,007.00	P.O.A	150mm Log*	£102,561.00	£1,007.00	P.O.A
The Mendip - 3 Bedrooms - 128.18m ² (1380ft ²)				The Cambrian - 4 Bedrooms - 128.18m ² (1380ft ²)			
75mm Log	£107,674.00	£1,058.00	£9,746.00	75mm Log	£108,310.00	£1,058.00	£9,826.00
150mm Log*	£126,656.00	£1,007.00	P.O.A	150mm Log*	£129,631.00	£1,007.00	P.O.A

Prices are a guide only based upon a 50 mile radius from Reading, they exclude veranda decking & railings, scaffolding and site preliminaries, the actual price will be based upon the site postcode, access, site conditions and provision of a suitable pitch upon which to site the lodge. The above prices are INCLUSIVE of V.A.T. where applicable. *Mobile Homes that comply with BS EN3632-2005 or better are zero rated for V.A.T. unless there are any Planning restrictions on use then an additional 5% VAT charge will apply.

The above prices are subject to currency exchange fluctuations and are based upon a rate of 11.00 Nkrone to £ Sterling
All prices are subject to a site survey and written quotation in accordance with our Standard Terms and Conditions of Contract.

Specification

Walls & Partitions

75mm Log

75mm(3") nominal laminated log walls with shallow round profile incorporating double tongue and groove. Shaped, rebated draught-proof interlocking corner joints allowing a natural settlement allowance of 2mm per log in the design and manufacturing process. Base log to external walls incorporates a cill projection with drip detail on the exterior log face.

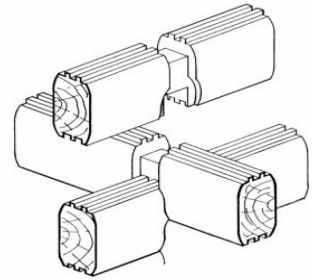

BS3632-2015 Upgrade

Log walls as described above with a slip batten system fixed to the internal face incorporating an air space and Earthwool insulation batts, lined internally with a vapour barrier and finished with 21mm split log profile cladding to match the log walls to all areas except the kitchen and bathroom areas which are left ready for finishing by others. Roof insulation upgraded to Celotex insulation for improved insulation levels.

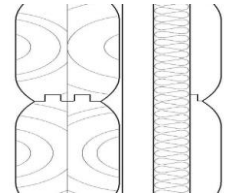

150mm Log

150mm(6") nominal laminated log walls with shallow round profile incorporating triple tongue and groove. Shaped, rebated draught-proof interlocking corner joints allowing a natural settlement allowance of 2mm per log in the design and manufacturing process. Base log to external walls incorporates a cill projection with drip detail on the exterior log face. Complies to BS3632-2005 and is therefore zero rated for VAT.

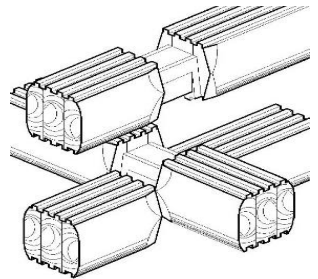

Roof Construction

34mm (1½") nominal roof planks, tongued and grooved with extended tongue profile, spanning between laminated beams. Softwood rafters fixed over the roof boarding with insulation laid between with a vented air space over. Moisture resistant board fixed over rafters ready to receive roof finish.

Roof Finish

Heavy duty glassfibre reinforced bitumen shingles, to clients colour and design choice, are fixed to boarding with galvanised staple fixings.

Sub-Frame & Floor Construction

Laminated timber sub-frame beams to structural engineers design supporting 'I' beam joists with insulation laid between the joists. Floor finished with TG V313 moisture resistant chipboard ready to receive floor covering by others. Underlining finished with OSB-3 exterior board.

Joinery

Purpose made doors and windows manufactured in laminated Nordic softwood, double vacuum impregnated. Security benefits include security locks, lockable handles and toughened low 'E' double glazing as standard and incorporate night trickle ventilation. Internal doors are high quality pine panel style with locks and bathroom latches as required. All joinery is factory finished to client's colour choice.

Rainwater Goods

Half round black uPVC guttering with down pipes and all fittings as necessary.

Timber & Preservative Treatment

All logs are kiln dried slow grown North European spruce or pine, from regulated and managed forests. The log sections are formed by laminating sections together with the durable heartwood to the outside face. Logs are finger jointed and stress graded where necessary. Natural Oil based woodstain treatment is applied to all timber on site upon completion of the assembly to the clients colour choice from our standard colour range. Two coats are brush applied to all external timber work. The internal coating is applied by low pressure high volume spray system.

Delivery

Delivery of the lodge on site on to a prepared pitch, provided by others in accordance with our requirements. Costs will be subject to distance from Reading, Berkshire, site conditions and access.

Note: Veranda decking and handrailing, price available upon request. Internal fitout to be undertaken by client and is shown for illustration purposes only

Norwegian Log maintains a policy of continual product improvement and reserves the right to change and amend our specification without prior notice