

Garden Buildings Range | Home Office | Garden Room | Studio | Garden Retreat

(0-)

(Y3)



design
portfolio



for living...for leisure...for business



Extra space at home without moving or extending

for living

convenient extra accommodation

for leisure

delightful garden rooms

for business

for a productive home office



Whatever your reason for owning a Norwegian Log building, you'll appreciate the low maintenance and running costs all year round. The draught-free solid log provides a high level of natural insulation, keeping you warm in winter, cool in summer. And the light, airy Scandinavian styling harmonises with any garden.

This design portfolio covers Norwegian Log's standard buildings, which have been developed over the years as a result of feedback and suggestions from our many satisfied clients. The advantage of choosing a standard building is that you benefit from our economies of scale. Larger buildings and a bespoke design service are also available, but naturally they cost a little more.

All buildings are available in three formats - Office, Garden Room and Studio - with the largest buildings also available as Garden Retreats. But remember, these are simply convenient names. The Garden Retreat, for example, is also a superb large office.

Home Office - the unobstructed space that's vital for today's high-tech offices.

Garden Room - with a separate internal room suitable for a WC, or for storage.

Studio - has a larger separate internal room, e.g. for a shower/WC, that would make the building ideal for accommodating guests.

Garden Retreat - offering three well-planned rooms, including the possibility of a kitchenette to turn the building into a self-contained 'granny' annexe.



Individualise your Norwegian Log building

A range of options allows you to customise your building. Verandah decking, with attractive handrails and a sheltering extended roof, gives you a place to sit outside yet protected from the sun. Inside, Velux roof lights provide natural light that's particularly welcome in winter.

Quick and clean erection, with the services you want

Norwegian Log buildings are erected quickly and cleanly. We can build suitable foundations and install services (power and lighting, space heating, plumbing/sanitaryware). There's even a convenient kitchenette package. Please see the price list for details of prices and availability. Alternatively, you can arrange these items with your local contractors.

Planning Regulations

In most cases you won't need planning permission (subject to the Permitted Development Act) or Building Regulations approval for this range of standard Norwegian Log buildings. All the buildings in this range are under 4m total height. However, please contact Norwegian Log for advice and check your circumstances with your Local Authority. If planning permission is needed in your case, Norwegian Log can undertake the entire application on your behalf for £750.00 + VAT (excluding listed buildings). Your Local Authority's own fees are of course your responsibility.

The Organiser range of garden buildings



Approximate ridge height above ground level 3.33m (10'11")

Elevation and Floor Plan scale 1:100

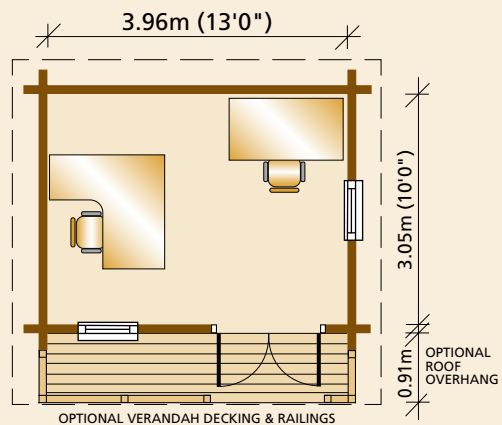

HOME OFFICE

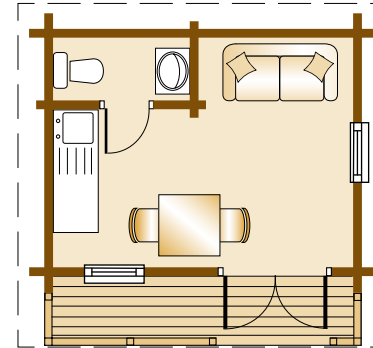

GARDEN ROOM

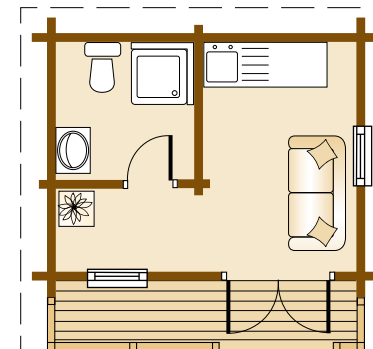

STUDIO

The various options shown here for furniture are examples only

The Manager range of garden buildings



Approximate ridge height above ground level 3.20m (10'6")

Elevation and Floor Plan scale 1:100

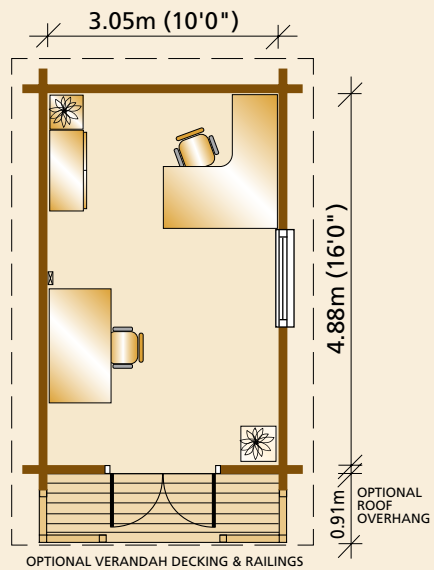

HOME OFFICE

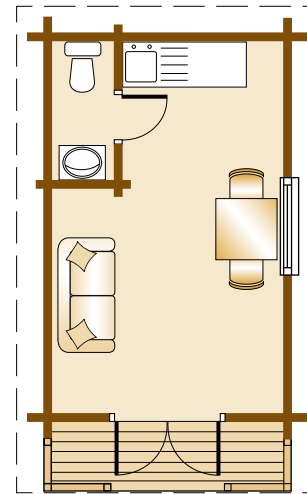

GARDEN ROOM

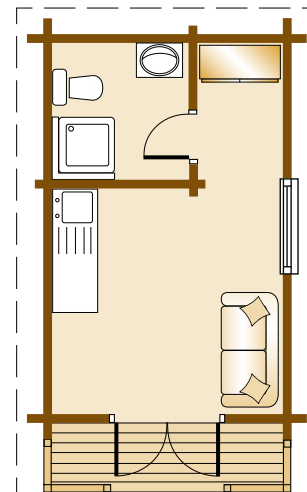

STUDIO

The various options shown here for furniture are examples only

The Manager Special range of garden buildings



Approximate ridge height above ground level 3.49m (11'5")

Elevation and Floor Plan scale 1:100

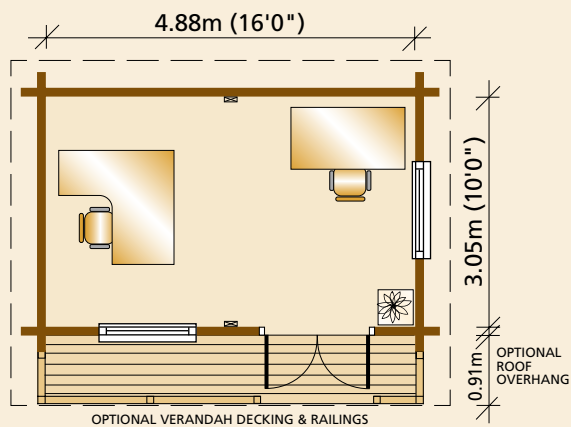

HOME OFFICE

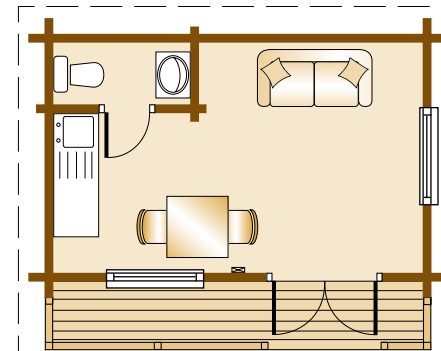

GARDEN ROOM

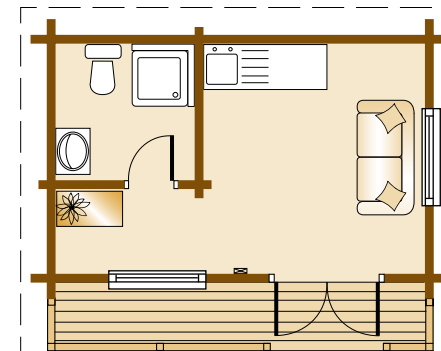

STUDIO

The various options shown here for furniture are examples only

The Administrator range of garden buildings



Approximate ridge height above ground level 3.41m (11'2")

Elevation and Floor Plan scale 1:100

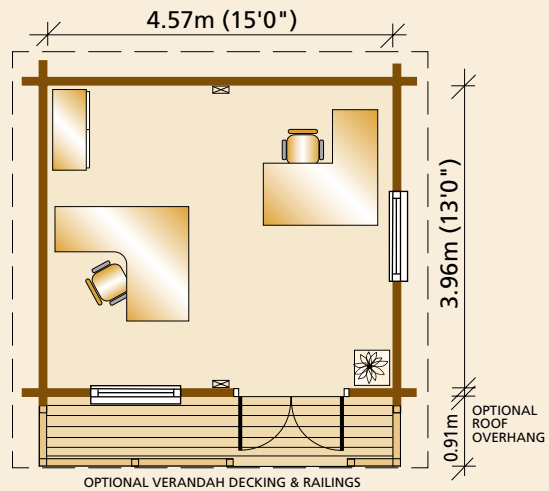

HOME OFFICE

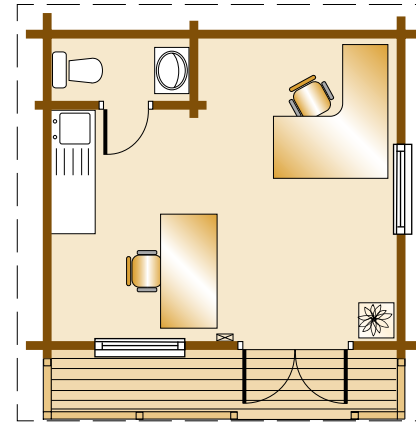

GARDEN ROOM

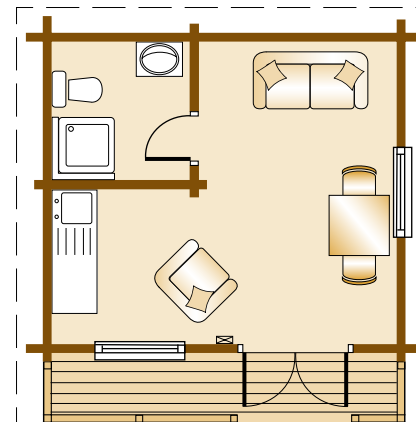

STUDIO

The various options shown here for furniture are examples only

The Executive and The Executive Special
range of garden buildings



Approximate ridge height above ground level 3.37m (11'0")

Elevation and Floor Plan scale 1:100

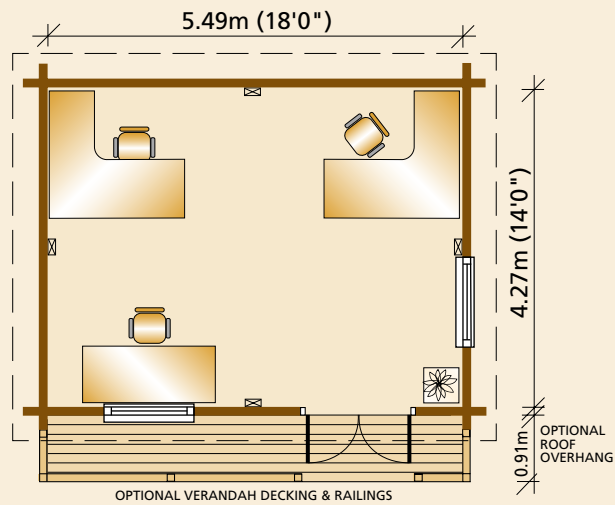

HOME OFFICE

The various options shown here for furniture are examples only



The Executive Special

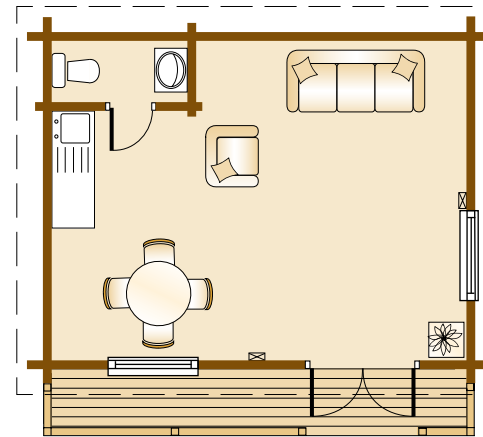

GARDEN ROOM

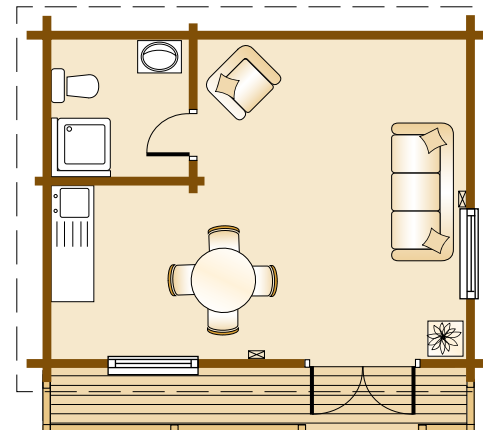

STUDIO

The Director range of garden buildings

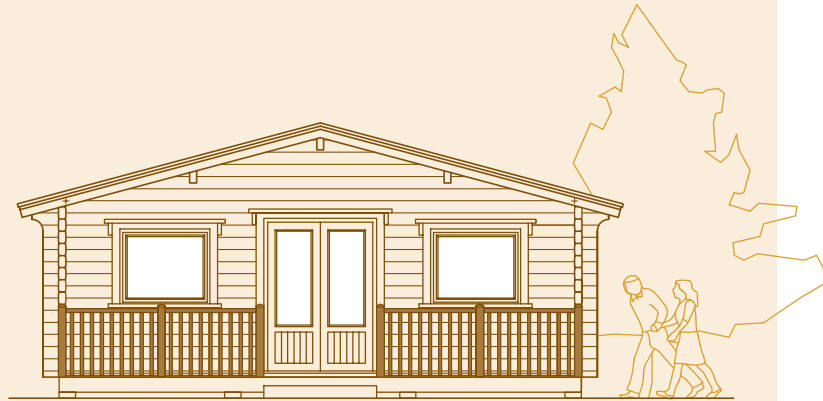

Approximate ridge height above ground level 3.70m (12'2")

Elevation and Floor Plan scale 1:100

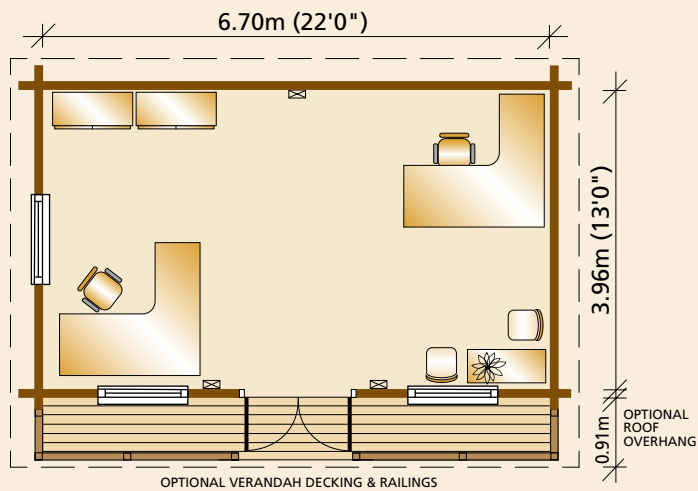

HOME OFFICE

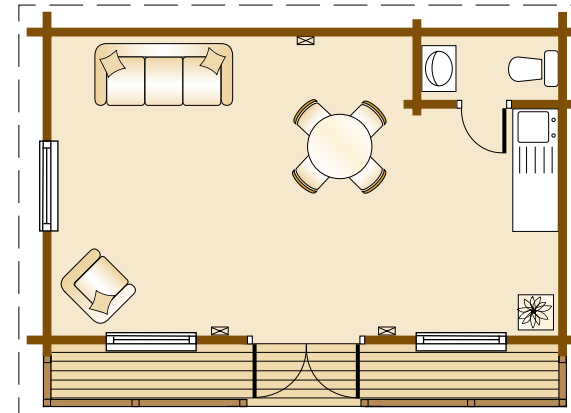

GARDEN ROOM

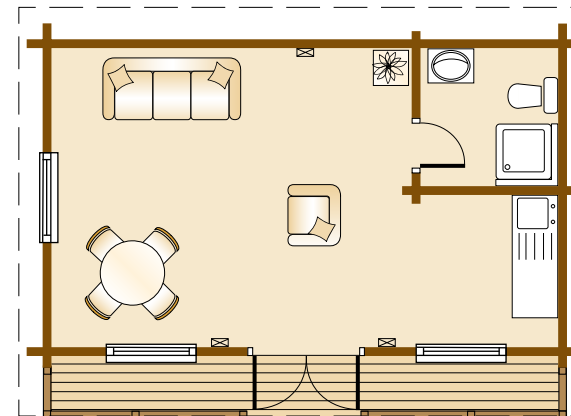

STUDIO

The various options shown here for furniture are examples only

The Managing Director range of garden buildings



Approximate ridge height above ground level 3.62m (11'10")

Elevation and Floor Plan scale 1:100

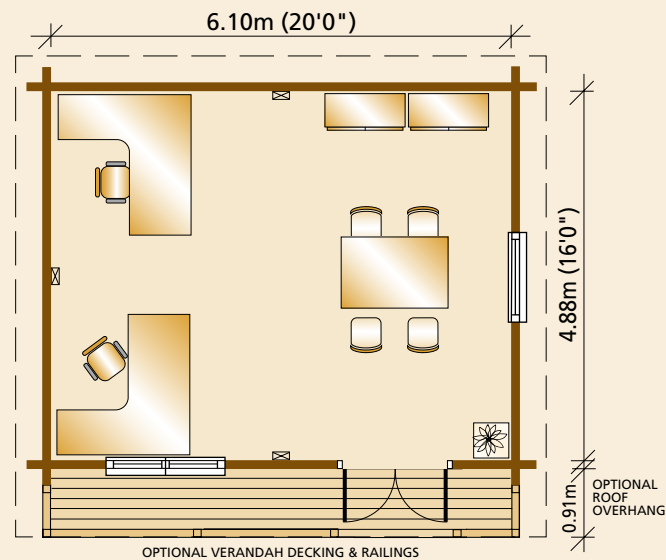

HOME OFFICE

The various options shown here for furniture are examples only

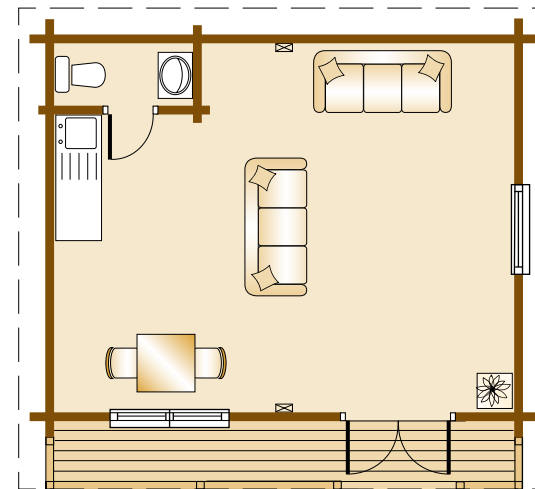

GARDEN ROOM

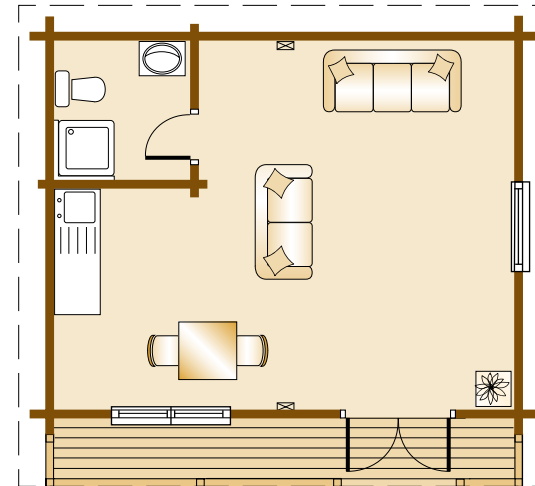

STUDIO

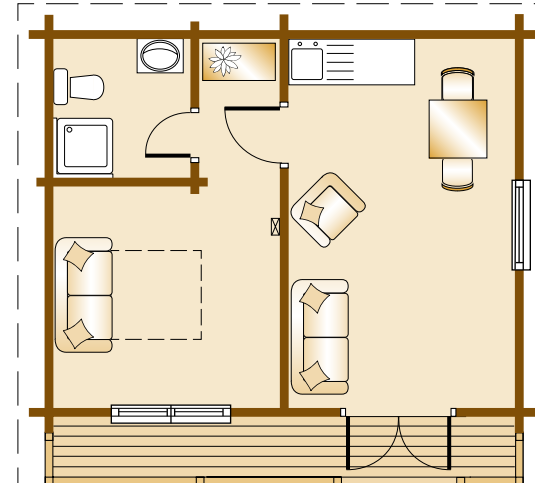

GARDEN RETREAT

The Vice Chairman range of garden buildings



Approximate ridge height above ground level 3.71m (12'2")

Elevation and Floor Plan scale 1:100

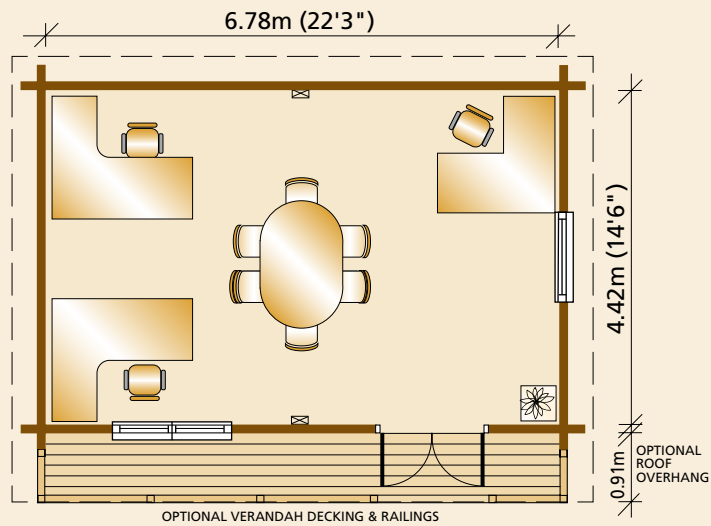

HOME OFFICE

The various options shown here for furniture are examples only

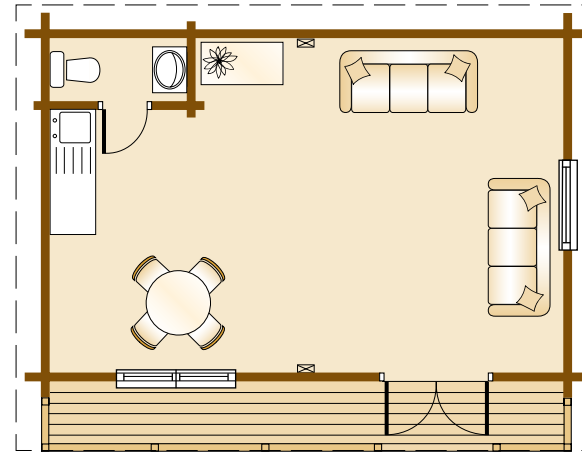

GARDEN ROOM

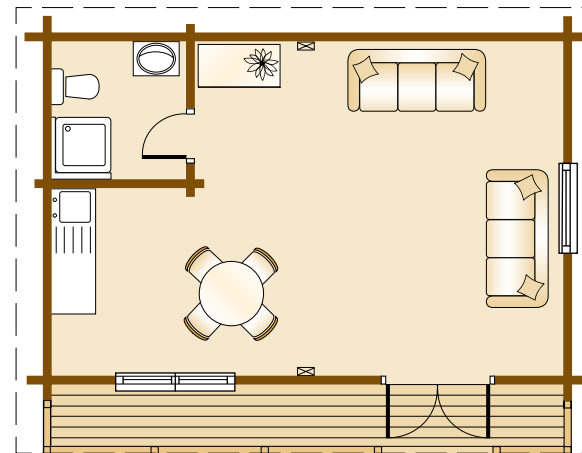

STUDIO

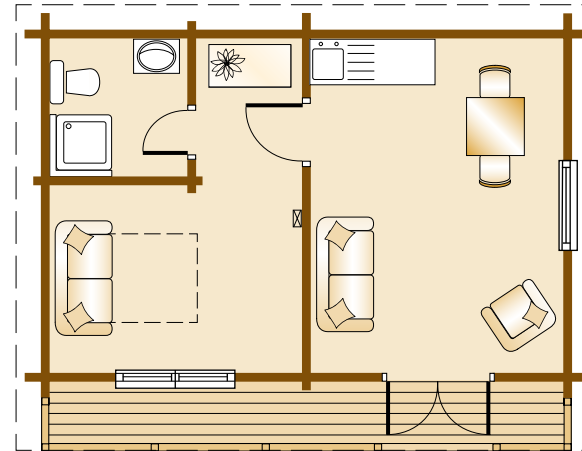

GARDEN RETREAT

The Chairman range of garden buildings



Approximate ridge height above ground level 3.82m (12'6")

Elevation and Floor Plan scale 1:100

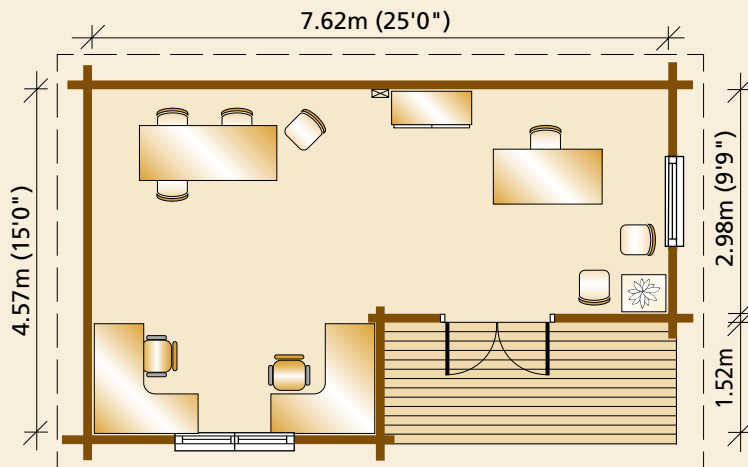

HOME OFFICE

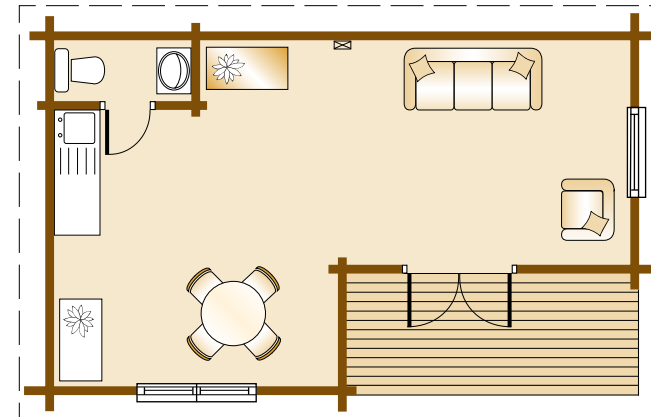

GARDEN ROOM

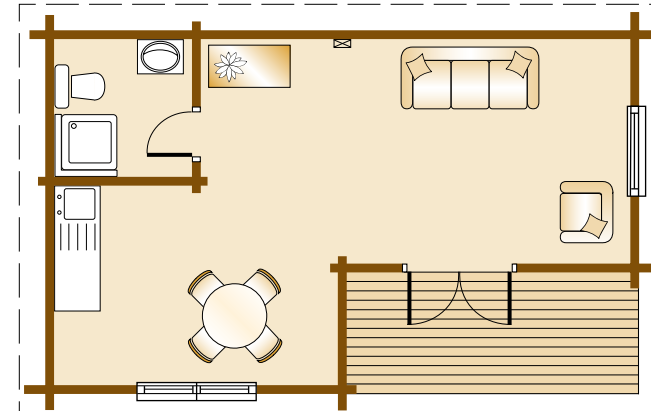

STUDIO

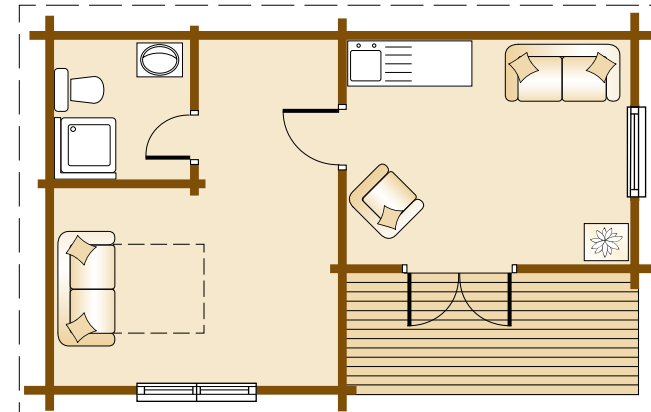

GARDEN RETREAT

The various options shown here for furniture are examples only

Norwegian Log Buildings

230 London Road, Reading, RG6 1AH
Telephone 0118 966 9236 Fax 0118 966 0456
Email: sales@norwegianlog.co.uk
Website: www.norwegianlog.co.uk